

Kühlart / Cooling method	Belastbarkeit / Rating [A] 60% (10 Min.) Mix [M21] CO <sub>2</sub>		Absaugleistung / Extraction capacity [Nm <sup>3</sup> /h]	Differenzdruck / Differential pressure [Pa]
Gas / gas	150	180	40	1.50

Typ / Type	Draht-Ø / Wire diam. [mm]	Anschluss / Connector	Biegung / Bend	Art. Nummer / Part no.
<b>TBI 150 E3</b>	0.6 - 1.0	Euro	50°	202P3X13_0*

**Stromdüsen / Contact tips**

▶ <b>M6x25, ECu</b>	<b>340P__1073*</b>
M6x25, CuCrZr	340P__3073*
M6x25 Alu, ECu	341P__1073*

**Gasdüsen / Gas nozzles**

NW 12  
345P012402  
lange Isolation/  
long insulation

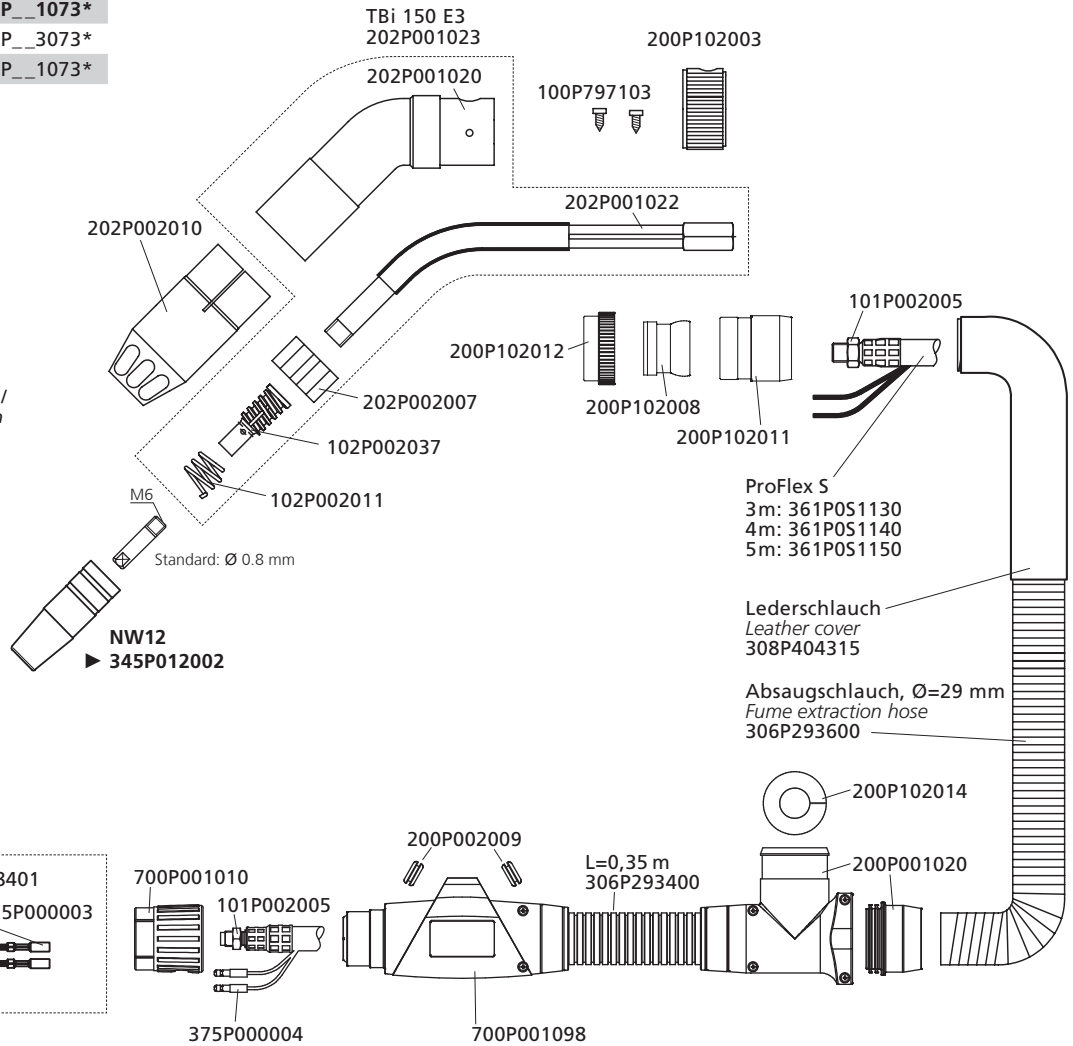
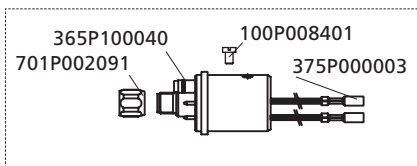
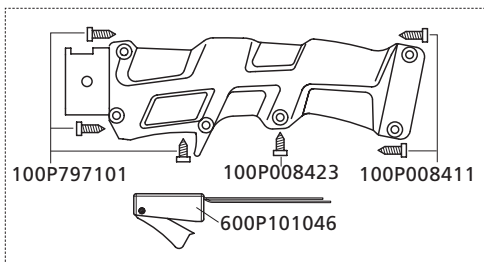

NW 16  
345P011402  
lange Isolation/  
long insulation

**ESG kpl. / ESG cpl.**  
 701P001048

**Griffschale kpl. / Handle cpl. kit**  
 380P200606

## ▶ Standard / Standard

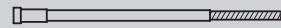
\*Bitte an Leerstelle entsprechende Angaben für Brennerlänge oder Drahtdurchmesser einsetzen, z.B. 08 für 0.8 mm oder 3 für 3 m. / At the blank, please insert suitable information for torch length or wire diameter, e.g. 08 for 0.8 mm or 3 for 3 m.

**Drahtführungen / Wire guides**

	m	Ø 0.6 - 0.9	Ø 0.8 - 1.0
<b>Drahtführungsspirale für Stahldraht</b> Liner for steel wire		weiß / white	blau / blue
	3	324P133834	▶ 324P154534
	4	324P133844	▶ 324P154544
	5	324P133854	▶ 324P154554
<b>PTFE-Seele für Alu- und Edelstahldraht</b> PTFE liner for alu- and stainless steel wire			blau / blue
	3	-	326P154035
	4	-	326P154045
	5	-	326P154055