

Kühlart / Cooling method	Belastbarkeit / Rating [A] 60% (10 Min.) Mix [M21] CO ₂		Absaugleistung / Extraction capacity [Nm ³ /h]	Differenzdruck / Differential pressure [Pa]
Gas / gas	200	230	40	1.15

Typ / Type	Draht-Ø / Wire diam. [mm]	Anschluss / Connector	Biegung / Bend	Art. Nummer / Part no.
TBi 250 E3	0.8 - 1.2	Euro	50°	204P3X13_0*

Düsenstock / Tip holder

- ▶ **M6 / L=35 mm** **342P006003**
- M8 / L=35 mm 342P008003

Stromdüsen / Contact tips



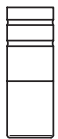
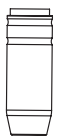

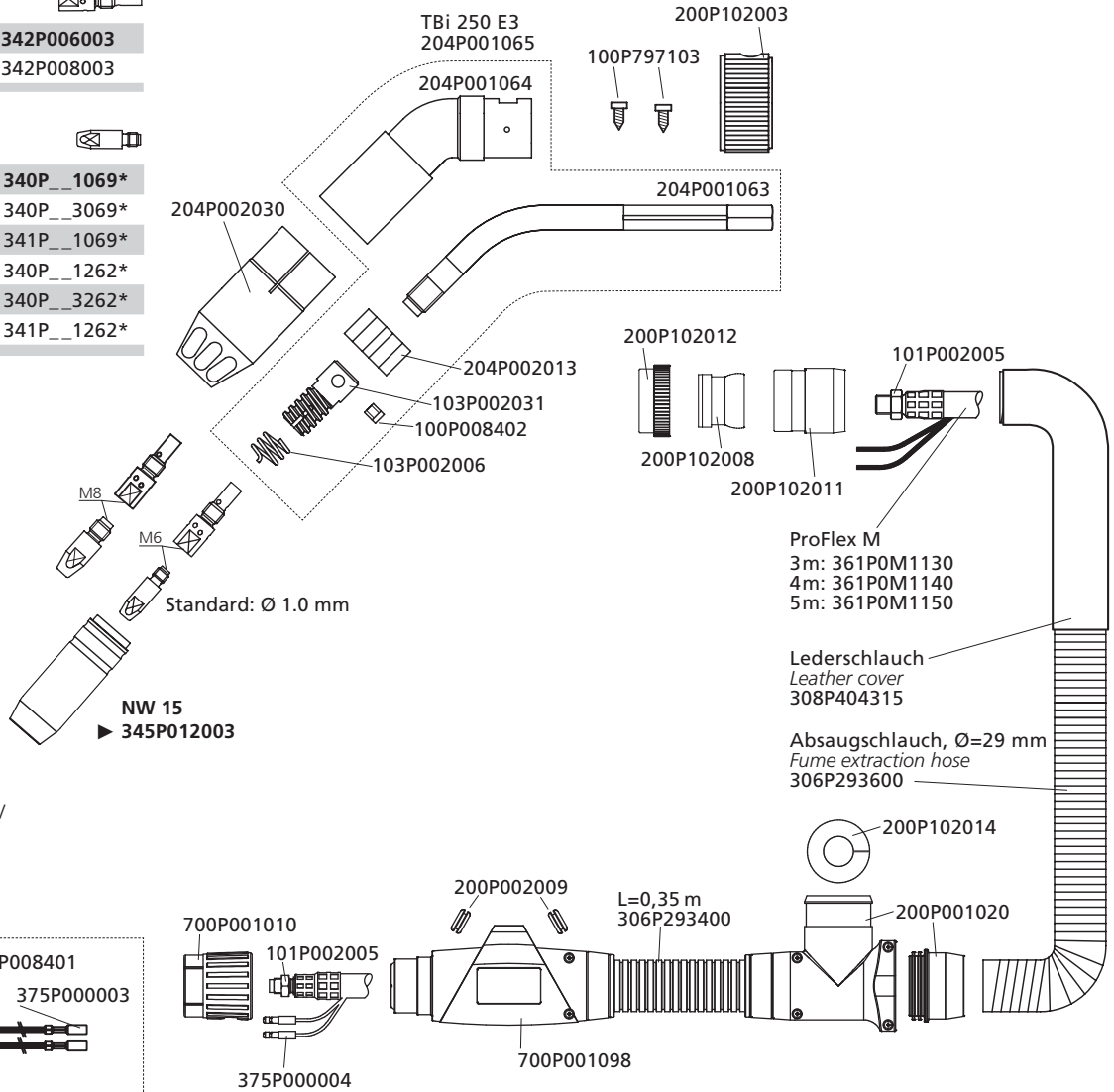
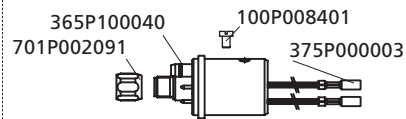
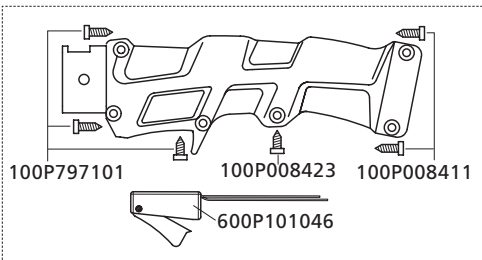
- ▶ **M6x28, ECu** **340P__1069***
- M6x28, CuCrZr 340P__3069*
- M6x28 Alu, ECu 341P__1069*
- M8x30, ECu 340P__1262*
- M8x30, CuCrZr 340P__3262*
- M8x30 Alu, ECu 341P__1262*

Gasdüsen / Gas nozzles

 NW 20
345P011003

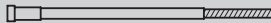
 NW 15
345P012303
lange Isolation/
long insulation

 NW 20
345P011303
lange Isolation/
long insulation

ESG kpl. / ESG cpl.
701P001048

Griffschale kpl. / Handle cpl. kit
380P220606

▶ Standard / Standard

*Bitte an Leerstelle entsprechende Angaben für Brennerlänge oder Drahtdurchmesser einsetzen, z.B. 08 für 0.8 mm oder 3 für 3 m. / At the blank, please insert suitable information for torch length or wire diameter, e.g. 08 for 0.8 mm or 3 for 3 m.

Drahtführungen / Wire guides	m	Ø 0.8 - 1.0	Ø 1.0 - 1.2
Drahtführungsspirale für Stahldraht Liner for steel wire	3	blau / blue	rot / red
	4	324P154534	▶324P204534
	5	324P154544	▶324P204544
	5	324P154554	▶324P204554
PTFE-Seele für Alu- und Edelstahldraht PTFE liner for alu- and stainless steel wire	3	blau / blue	rot / red
	3	326P154035	326P204035
	4	326P154045	326P204045
	5	326P154055	326P204055
PA-Seele mit Bronzespirale für Aludraht PA liner with bronze liner for alu wire	3	anthrazit / anthracite	—
	3	328P20403A	—
	4	328P20404A	—
	5	328P20405A	—
Drahtführung für Tbi DR Brennerhäse Liner for Tbi DR torch necks		322P204005	322P204005
