

Kühlart / Cooling method	Belastbarkeit / Rating [A] 60% (10 Min.) Mix [M21] CO2	Absaugleistung / Extraction capacity [Nm³/h]	Differenzdruck / Differential pressure [Pa]
Gas / gas	300 330	55	2.60

Typ / Type	Draht-Ø / Wire diam. [mm]	Anschluss / Connector	Biegung / Bend	Art. Nummer / Part no.
TBI 360 E3	1.0 - 1.6	Euro	50°	214P3X13_0*

### Düsenstock / Tip holder



▶ M6 / L=28 mm	342P006014
M6 / L= 32 mm	342P006114
▶ M8 / L= 28 mm	342P008014
M8 / L= 34 mm	342P008114

### Gasverteiler / Gas diffusers



▶ Schwarz / Black	114P002007
Keramik / Ceramic	114P002005

### Stromdüsen / Contact tips



▶ M6x28, ECu	340P__1069*
M6x28, CuCrZr	340P__3069*
M6x28 Alu, Ecu	341P__1069*
▶ M8x30, ECu	340P__1262*
M8x30, CuCrZr	340P__3262*
M8x30 Alu, Ecu	341P__1262*

### Gasdüsen / Gas nozzles

### Absaugdüsen / Fume shroud

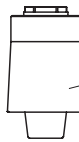
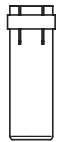

Absaugdüse mit integrierter Gasdüse, keine zusätzliche Gasdüse nötig./  
Fume shroud with integrated gas nozzle, no additional gas nozzle necessary.

NW 20  
345P011010

200P002045

200P101004

ESG kpl. / ESG cpl.  
701P001048

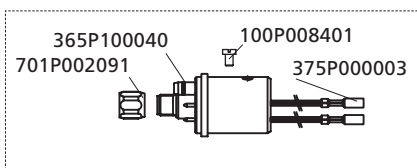

Griffschale kpl. / Handle cpl. kit  
380P200606

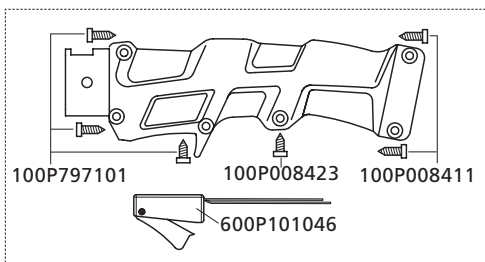

▶ Standard / Standard

\*Bitte an Leerstelle entsprechende Angaben für Brennerlänge oder Drahtdurchmesser einsetzen, z.B. 08 für 0.8 mm oder 3 für 3 m.  
At the blank, please insert suitable information for torch length or wire diameter, e.g. 08 for 0.8 mm or 3 for 3 m.

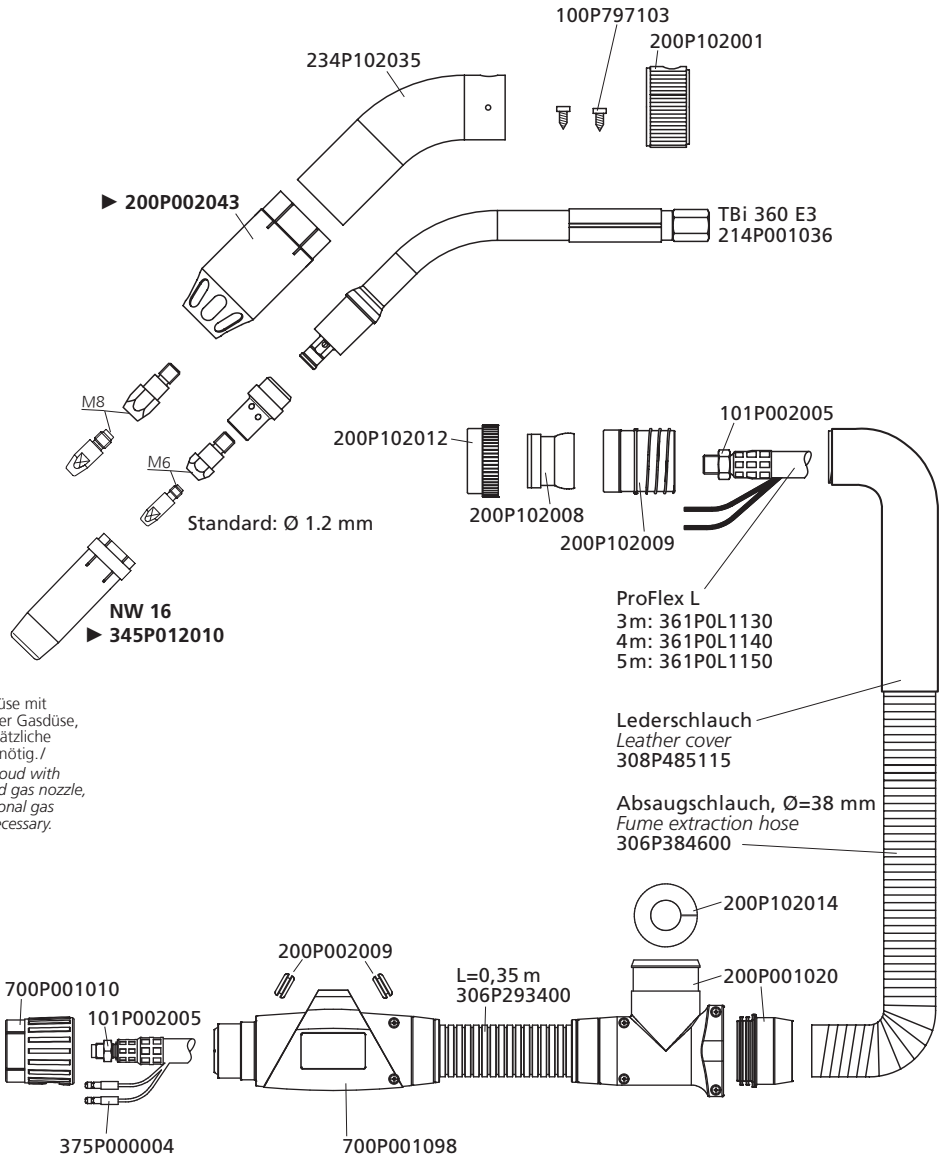

### Drahtführungen / Wire guides

	m	Ø 0.8 - 1.0	Ø 1.0 - 1.2	Ø 1.2 - 1.6
Drahtführungsspirale für Stahldraht Liner for steel wire			rot / red	gelb / yellow
	3	—	▶ 324P204534	324P254534
	4	—	▶ 324P204544	324P254544
	5	—	▶ 324P204554	324P254554
PTFE-Seele für Alu- und Edelstahldraht PTFE liner for alu- and stainless steel wire			rot / red	gelb / yellow
	3	—	326P204035	326P274735
	4	—	326P204045	326P274745
	5	—	326P204055	326P274755
PA-Seele mit Bronzespirale für Aludraht PA liner with bronze liner for alu wire		anthrazit / anthracite		anthr. / anthracite
	3	328P20403A	—	328P23473A
	4	328P20404A	—	328P23474A
	5	328P20405A	—	328P23475A