

Kühlart / Cooling method	Belastbarkeit / Rating [A] 100% (10 Min.) Mix [M21] CO2	Absaugleistung / Extraction capacity [Nm³/h]	Differenzdruck / Differential pressure [Pa]
Wasser / water	270 300	40	1.73

Typ / Type	Draht-Ø / Wire diam. [mm]	Anschluss / Connector	Biegung / Bend	Art. Nummer / Part no.
TBI 241 E3	0.8 - 1.2	Euro	50°	223P4X15_0*

Düsenstock / Tip holder



- **M6 / L=26 mm** **342P006012**

Gasverteiler / Gas diffusers



- **Rot / Red** **112P002019**
- Schwarz / Black **112P002024**
- Keramik / Ceramic **112P002021**

Stromdüsen / Contact tips



- **M6x25, ECu** **340P__1073***
- M6x25, CuCrZr **340P__3073***
- M6x25 Alu, Ecu **341P__1073***
- M6x28, ECu **340P__1069***
- M6x28, CuCrZr **340P__3069***
- M6x28 Alu, Ecu **341P__1069***

Gasdüsen / Gas nozzles

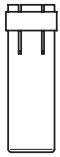

NW 17
345P011012

ESW kpl. / ESW cpl.
701P001049

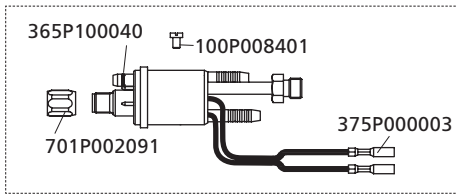

Griffschale kpl. / Handle cpl. kit
380P200606

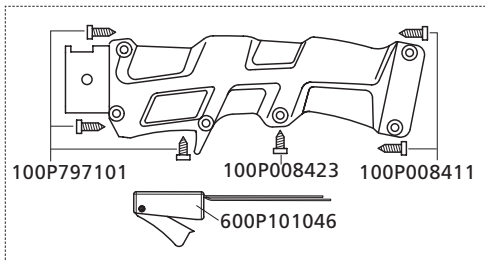

► Standard / Standard

*Bitte an Leerstelle entsprechende Angaben für Brennerlänge oder Drahtdurchmesser einsetzen, z.B. 08 für 0.8 mm oder 3 für 3 m. / At the blank, please insert suitable information for torch length or wire diameter, e.g. 08 for 0.8 mm or 3 for 3 m.

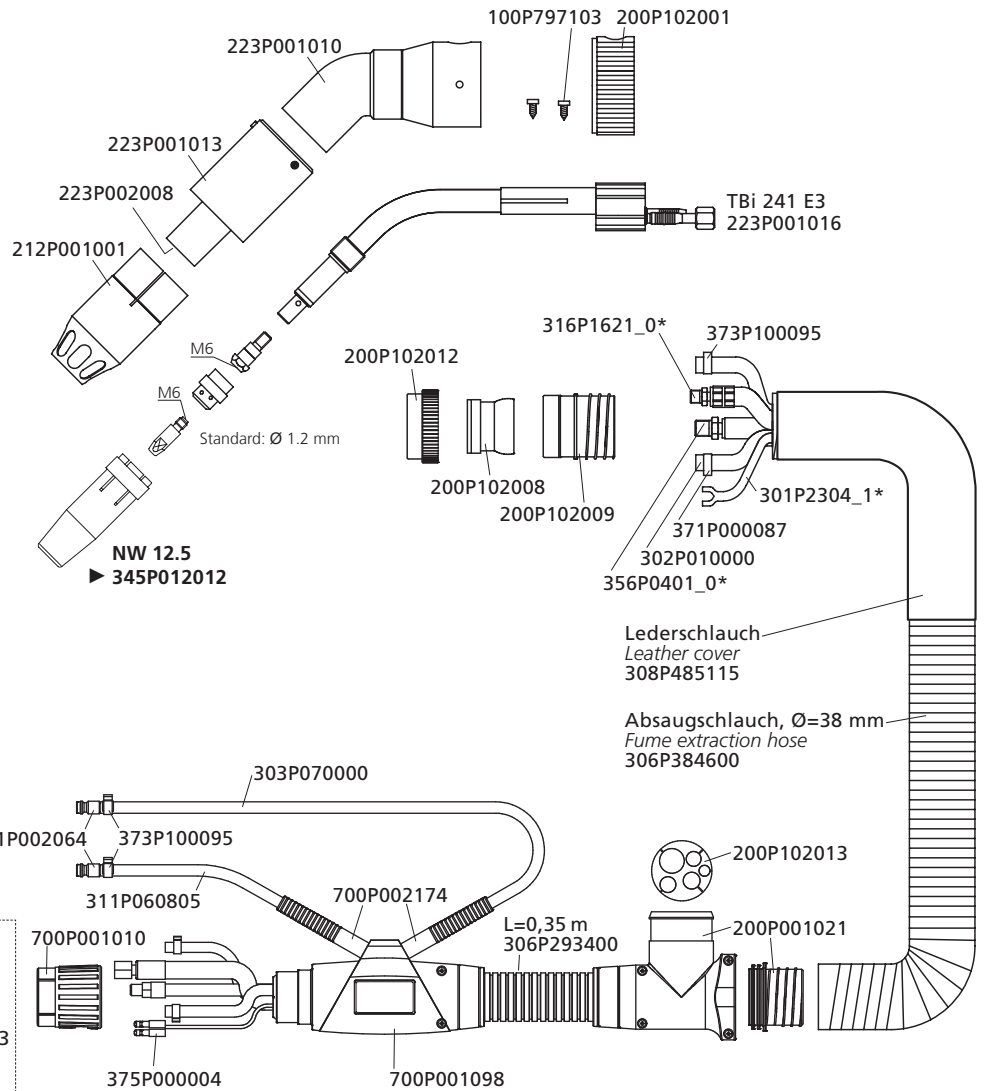

Drahtführungen / Wire guides

m Ø 0.8 - 1.0 Ø 1.0 - 1.2

Drahtführungsspirale für Stahldraht
Liner for steel wire

blau / blue blank / not insul.



- 3 324P154534 ► 322P204534
- 4 324P154544 ► 322P204544
- 5 324P154554 ► 322P204554

PTFE-Seele für Alu- und Edelstahldraht
PTFE liner for alu- and stainless steel wire

blau / blue rot / red

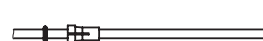

- 3 326P154035 326P204035
- 4 326P154045 326P204045
- 5 326P154055 326P204055

PA-Seele mit Bronzespirale für Aludraht
PA liner with bronze liner for alu wire

anthrazit / anthracite



- 3 328P20403A —
- 4 328P20404A —
- 5 328P20405A —