

Kühlart / Cooling method	Belastbarkeit / Rating [A]		Absaugleistung / Extraction capacity [Nm³/h]	Differenzdruck / Differential pressure [Pa]
	100% (10 Min.) Mix [M21]	CO2		
Wasser / water	450	450	50	1.70

Typ / Type	Draht-Ø / Wire diam. [mm]	Anschluss / Connector	Biegung / Bend	Art. Nummer / Part no.
<b>TBI 511 E3</b>	1.0 - 1.6	Euro	50°	234P4X15_0*

**Düsenstock / Tip holder**



▶ <b>M8 / L=25 mm</b>	<b>342P008033</b>
M8 / L=29 mm	342P008133
M6 / L=25 mm	342P006033
M6 / L=29 mm	342P006133

**Gasverteiler / Gas diffusers**

▶ <b>Schwarz / Black</b>	<b>130P002026</b>
Weiß / White	130P002017
Braun / Brown	130P002031

**Stromdüsen / Contact tips**

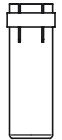
▶ <b>M8x30, ECu</b>	<b>340P__1262*</b>
M8x30, CuCrZr	340P__3262*
M8x30 Alu, ECu	341P__1262*
M6x28, ECu	340P__1069*
M6x28, CuCrZr	340P__3069*
M6x28 Alu, ECu	341P__1069*

**Gasdüsen /  
Gas nozzles**
**Absaugdüsen /  
Fume shroud**

Absaugdüse mit integrierter Gasdüse, keine zusätzliche Gasdüse nötig. /  
Fume shroud with integrated gas nozzle, no additional gas nozzle necessary.

NW 20  
345P011030

200P002045 200P101005

ESW kpl. / ESW cpl.  
701P001049

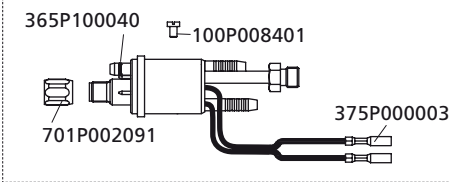

Griffschale kpl. / Handle cpl. kit  
380P220606

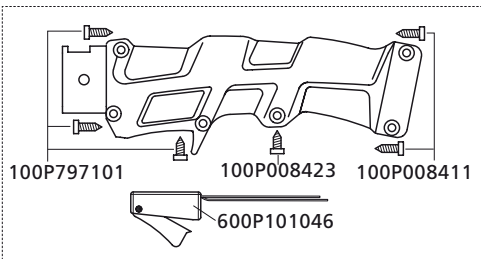

▶ Standard / Standard

\*Bitte an Leerstelle entsprechende Angaben für Brennerlänge oder Drahtdurchmesser einsetzen, z.B. 08 für 0.8 mm oder 3 für 3 m. /  
At the blank, please insert suitable information for torch length or wire diameter, e.g. 08 for 0.8 mm or 3 for 3 m.

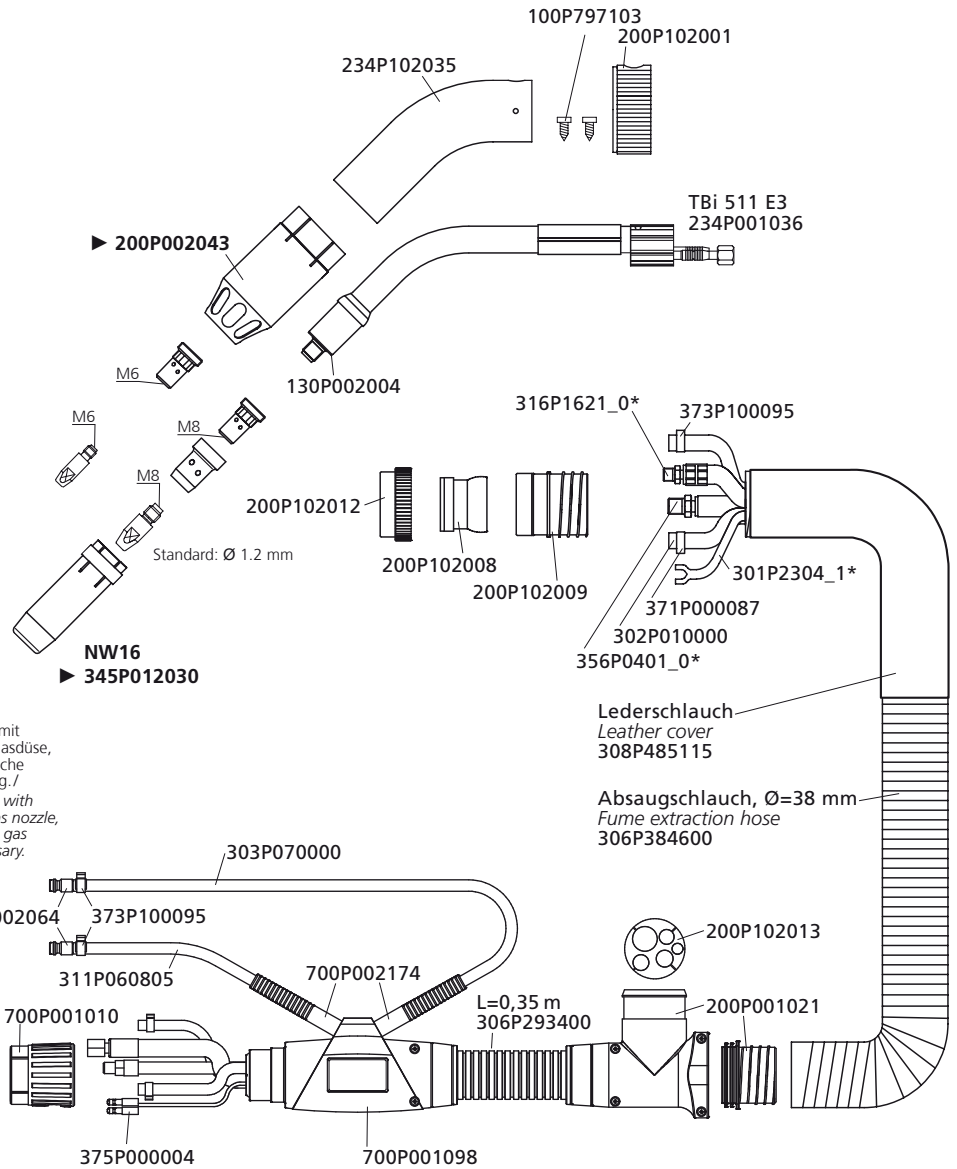
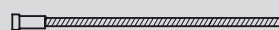
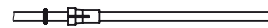
**Drahtführungen / Wire guides**
**Drahtführungsspirale für Stahldraht  
Liner for steel wire**

**PTFE-Seele für Alu- und Edelstahldraht  
PTFE liner for alu- and stainless steel wire**

**PA-Seele mit Bronzespirale für Aludraht  
PA liner with bronze liner for alu wire**

	m	Ø 0.8 - 1.0	Ø 1.0 - 1.2	Ø 1.2 - 1.6
Drahtführungsspirale für Stahldraht Liner for steel wire	3	—	blank / not insul.	blank / not insul.
	4	—	▶ 322P204534	322P254534
	5	—	▶ 322P204544	322P254544
PTFE-Seele für Alu- und Edelstahldraht PTFE liner for alu- and stainless steel wire	3	—	rot / red	gelb / yellow
	4	—	326P204035	326P274735
	5	—	326P204045	326P274745
PA-Seele mit Bronzespirale für Aludraht PA liner with bronze liner for alu wire	3	anthrazit / anthracite	—	anthrazit / anthracite
	4	328P20403A	—	328P23473A
	5	328P20404A	—	328P23474A
	5	328P20405A	—	328P23475A